

AVIGILON™

HORNSPEAKER

Installation Steps



In the Box

Included:

- (1) Speaker
- (2) Wall Bracket (attached to speaker)
- (3) Rear Lid
- (4) Screws for the rear lid (located inside the rear lid in a zip-lock bag)
- (5) Screws for attaching to the corner bracket/pole mount (located inside the rear lid in a zip-lock bag)
- (6) Cable Gland (attached to rear lid)
- (7) Microphone (attached to rear lid)

Required:

- T20 screwdriver
- 13mm spanner or socket wrench
- Wall fasteners (if mounting directly to surface)

*The wall bracket accommodates screws up to 6mm ($\frac{1}{4}$ ") in diameter.

*Installers must select appropriate fasteners for the mounting surface.

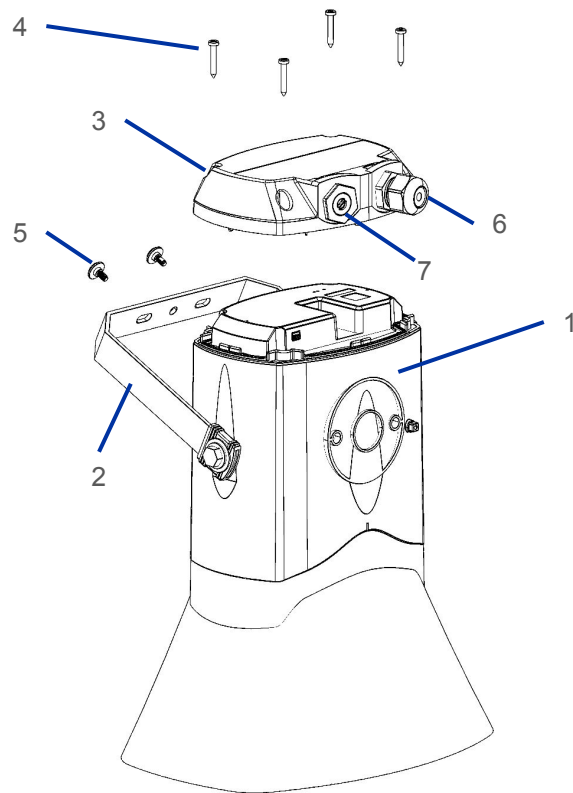

Using the wall bracket

1. Unscrew the wall bracket

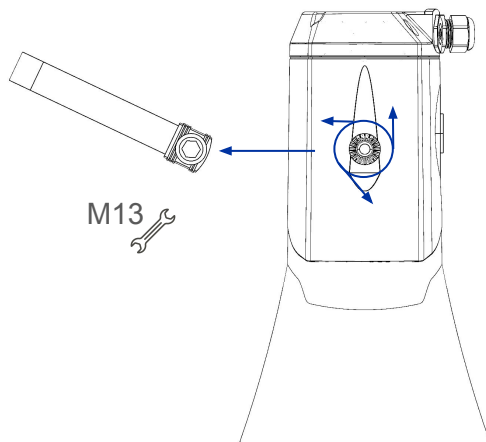

2. Fasten the wall bracket, beginning with the center fastener.

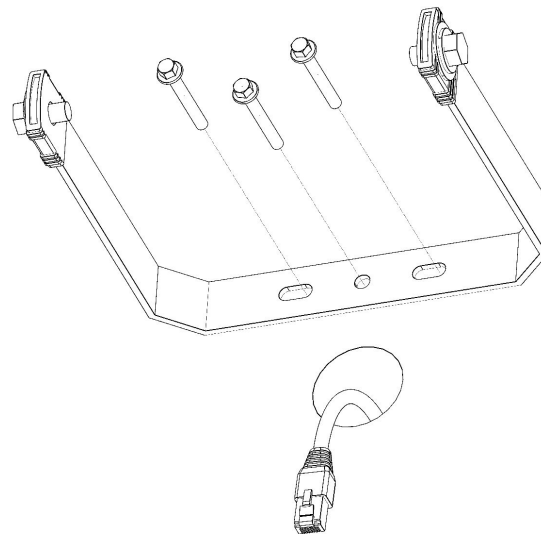

Installing the speaker to the bracket

3. Prepare the speaker for installation.

Remove the rear lid (1), cable gland (2), the rear lid screws(3) and the corner/pole-mount-screws (4)

*Ensure the rubber gasket attached to the lid remains in place during installation.

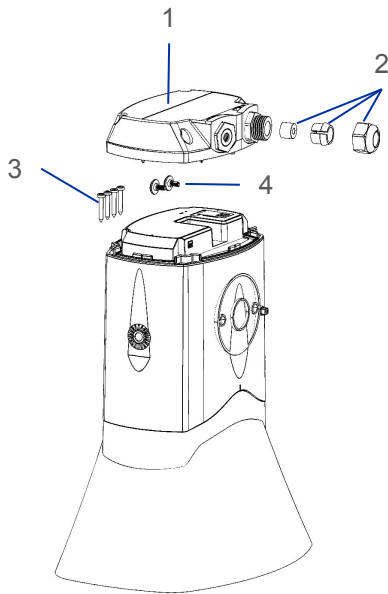

4. Install the speaker onto the bracket.

Loosely screw in the side bolts to allow for angle adjustment in subsequent steps.

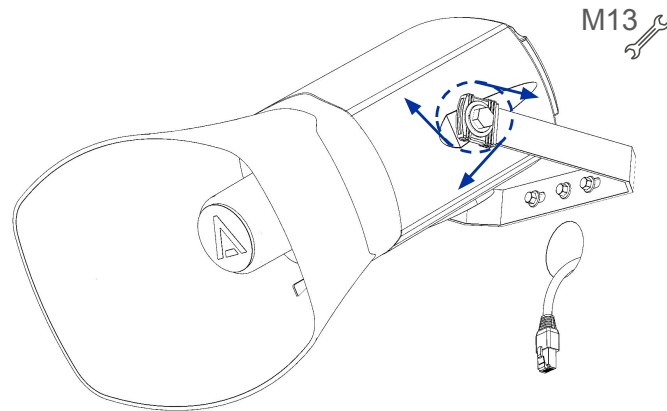

Installing the cables

5. Route Ethernet cable through the gland and into the rear lid.

*Do not make the nut on the cable gland tight in this step; the cable must be able to slide until the rear lid is in its final position.

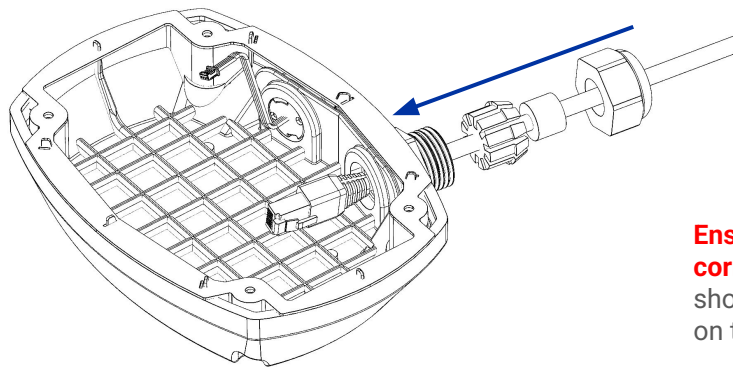

6. Connect the Ethernet and microphone cables.

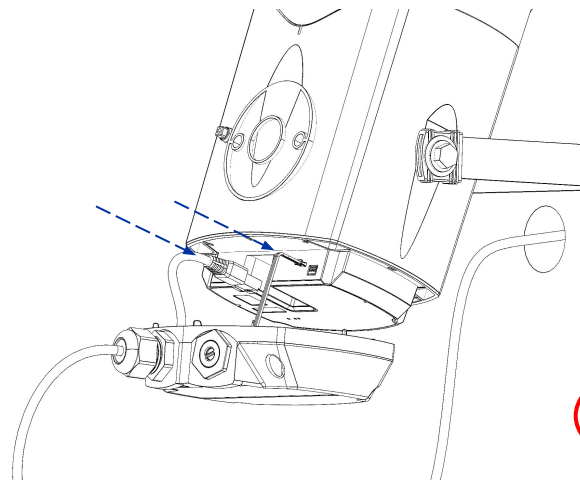

Ensure the microphone cable is correctly oriented; the white wire should align with the white dot on the product label.

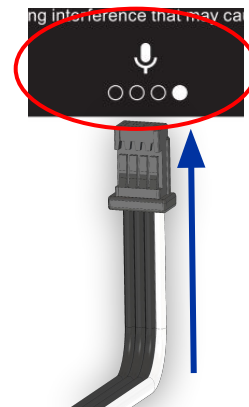

Installing the rear lid and tightening the cable gland

7. Install rear lid using provided screws.

*Make sure the cables are not getting pinched by the lid.

*Tightening torque = 1.3-1.8Nm

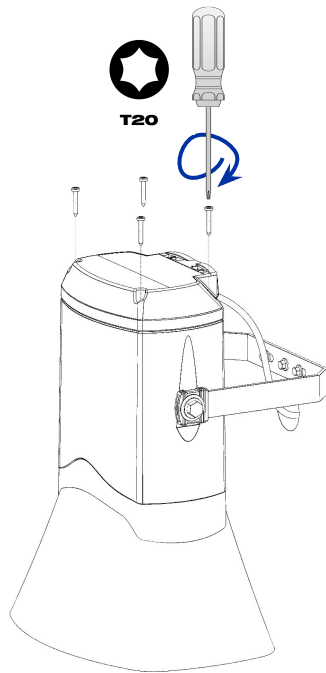

8. Hand-tighten the nut on the cable gland firmly.

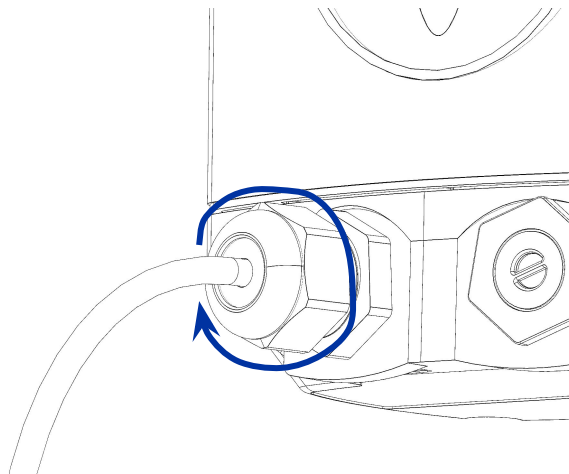

Finishing the installation

9. Adjust the speakers tilt angle and tighten the bolts

Adjust the speaker's tilt angle and tighten the bolts. Ensure the speaker points slightly downwards to prevent water accumulation. Finally, tighten the side screws to 5-6Nm to secure the angle.

